

...wedi®

wedi Fundo *Riolito/Riofino*

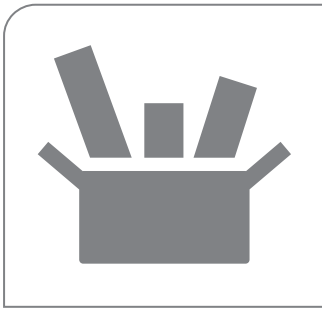

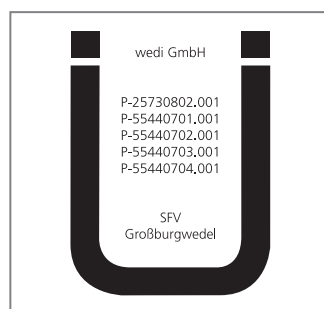

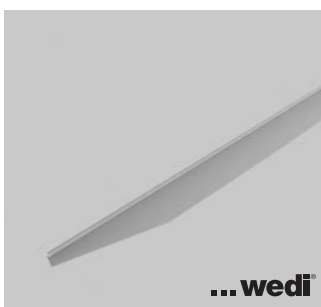
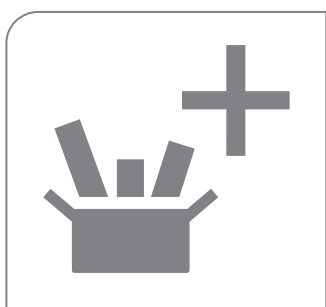
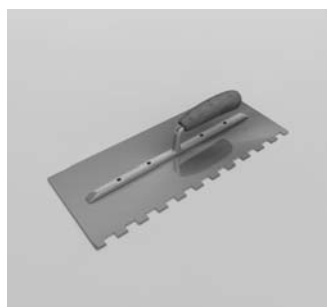
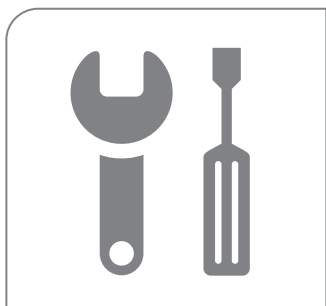

wedi GmbH

P-25730802.001
P-55440701.001
P-55440702.001
P-55440703.001
P-55440704.001

SFV
Großburgwedel

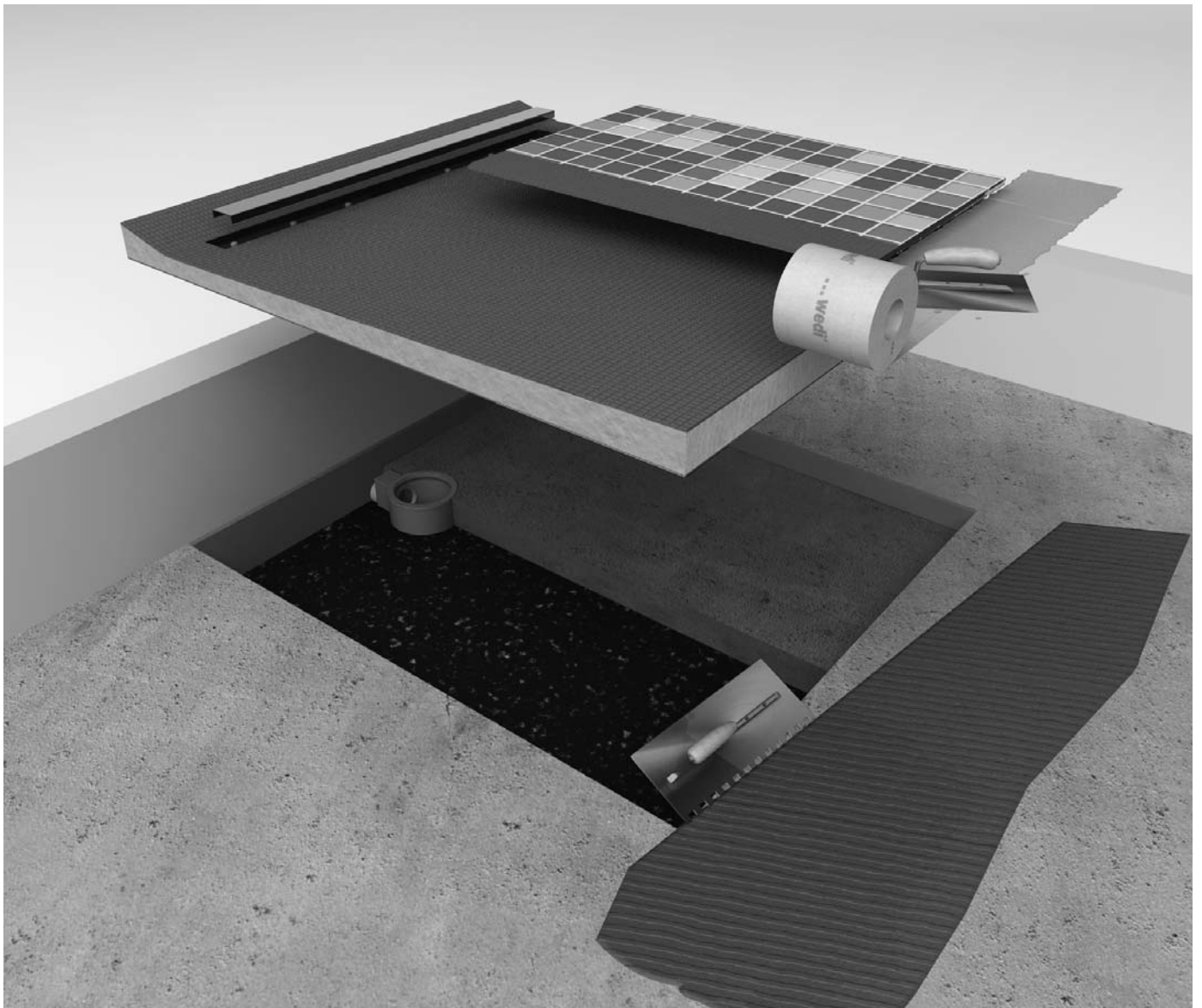

A

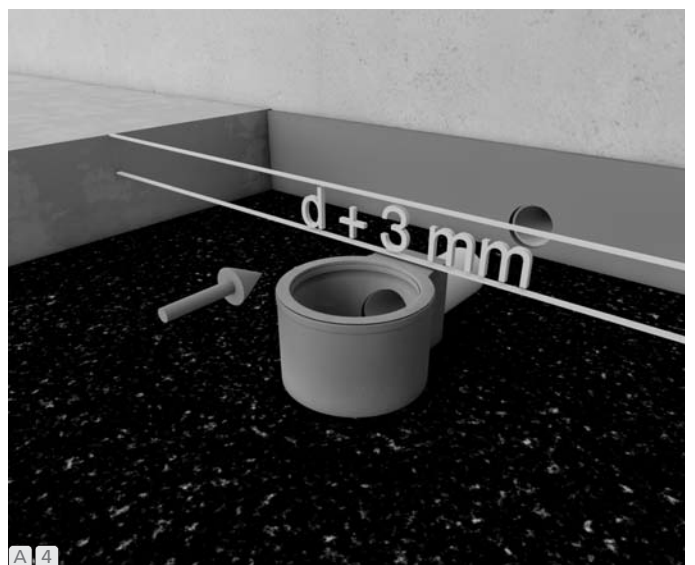
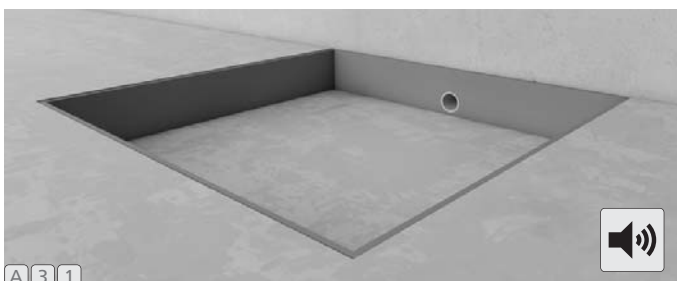
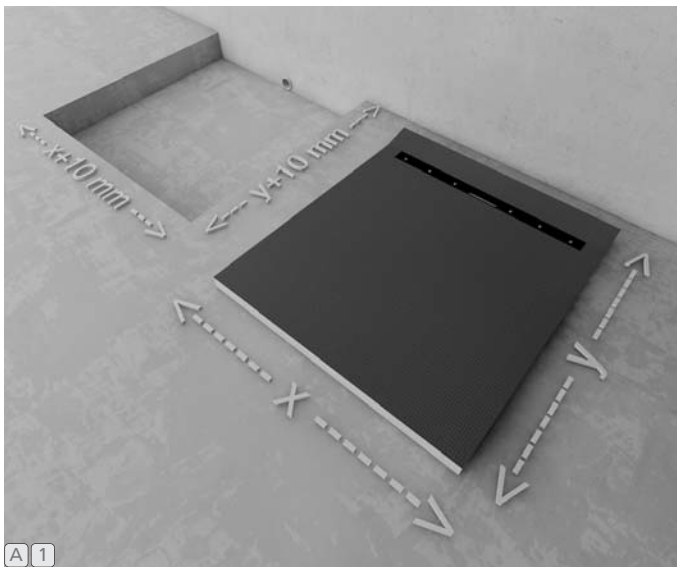
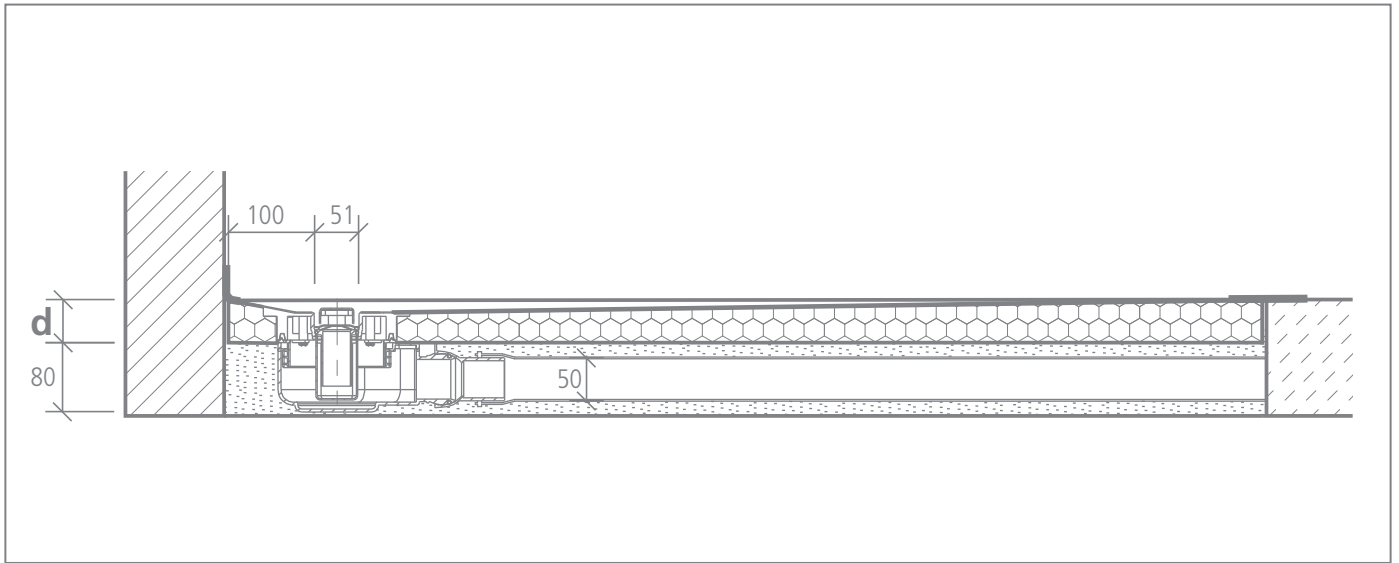

B

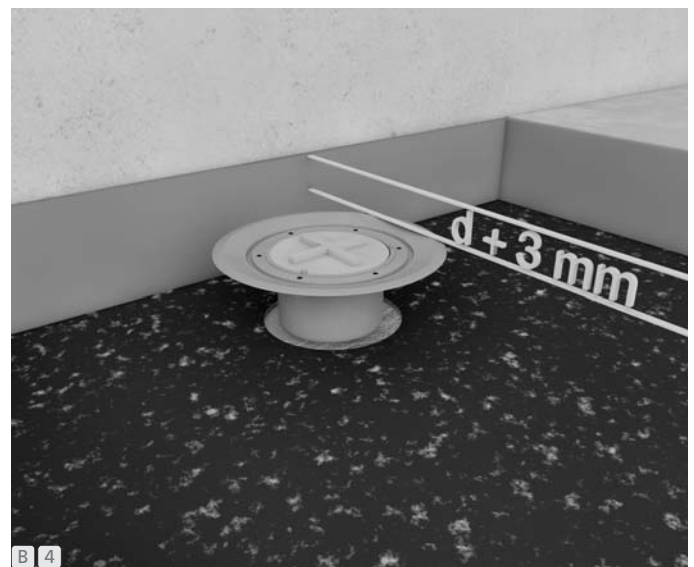
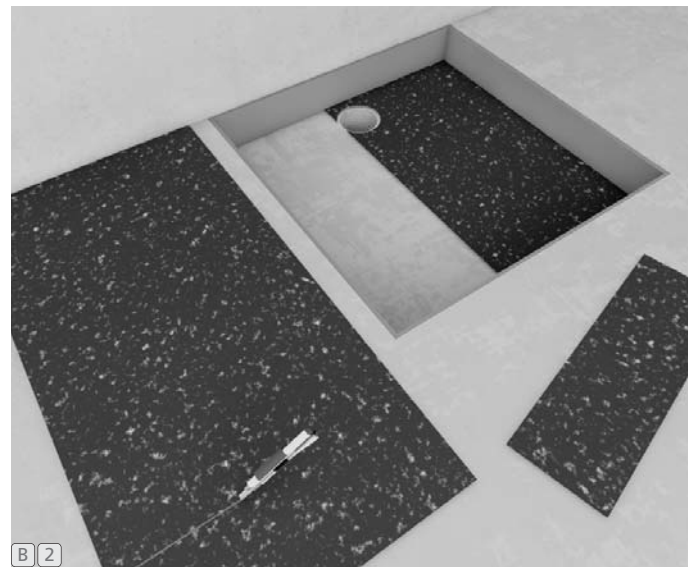
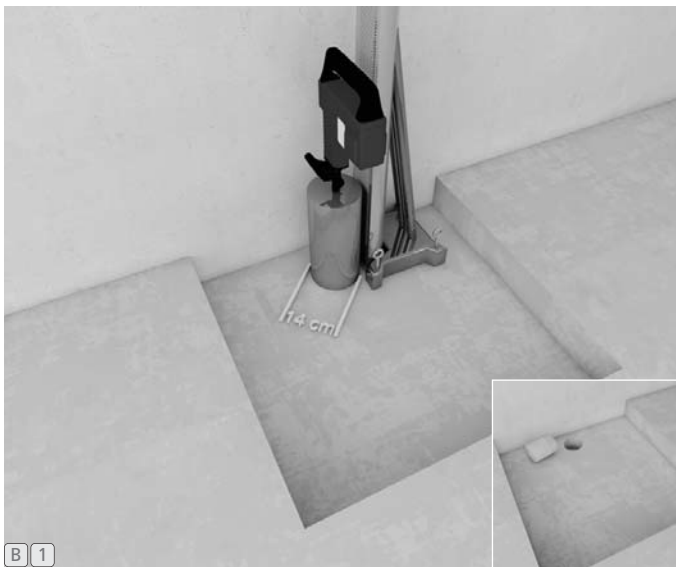
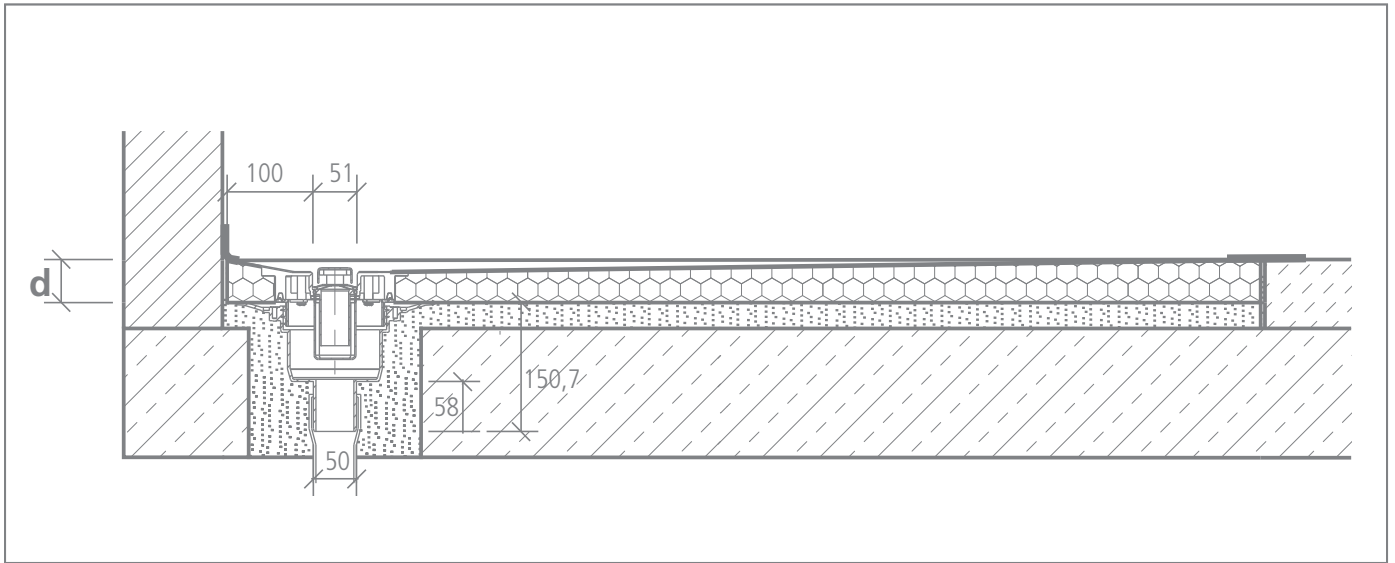

C

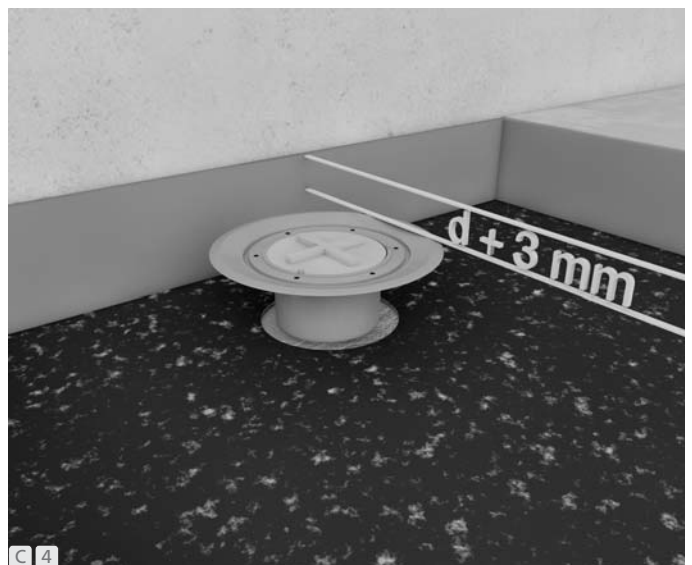
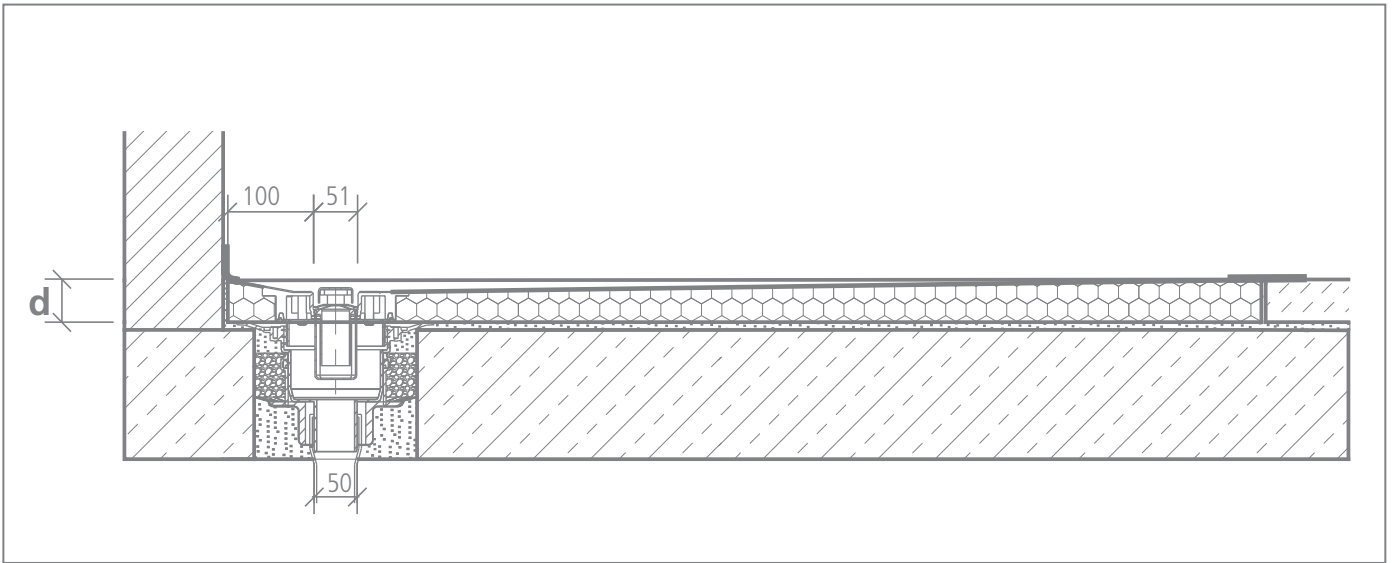

A, B, C

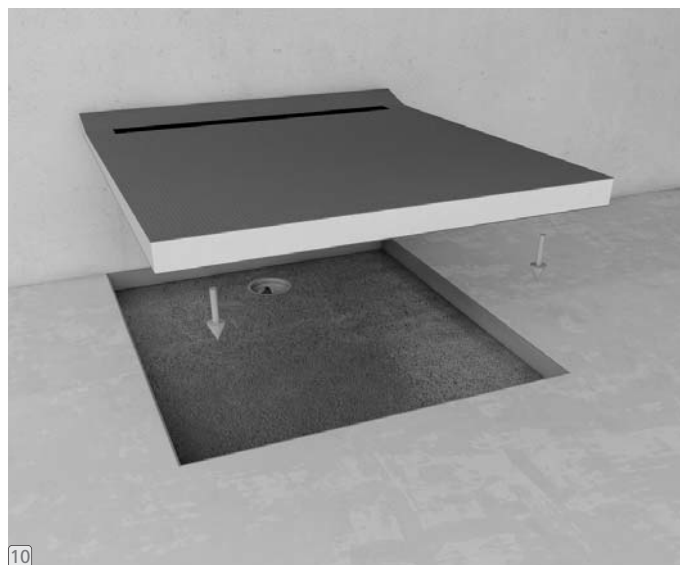
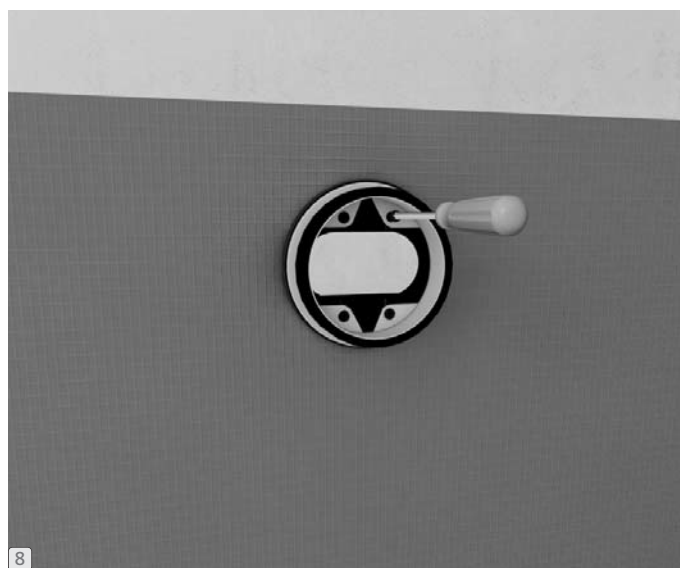

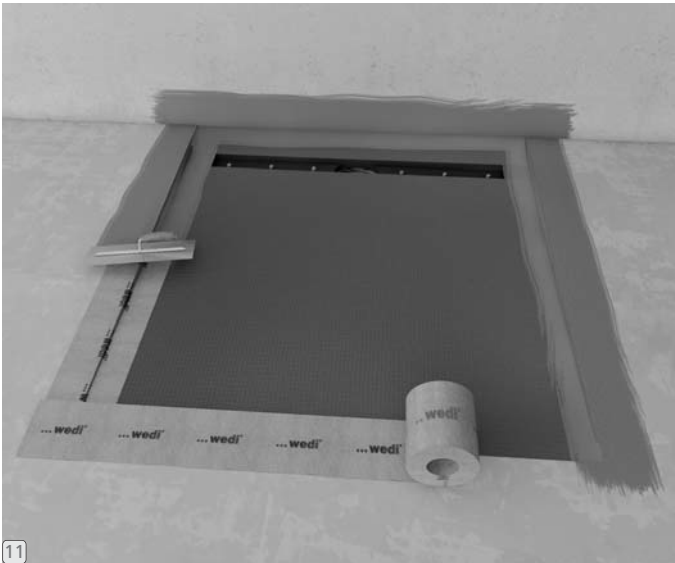

11

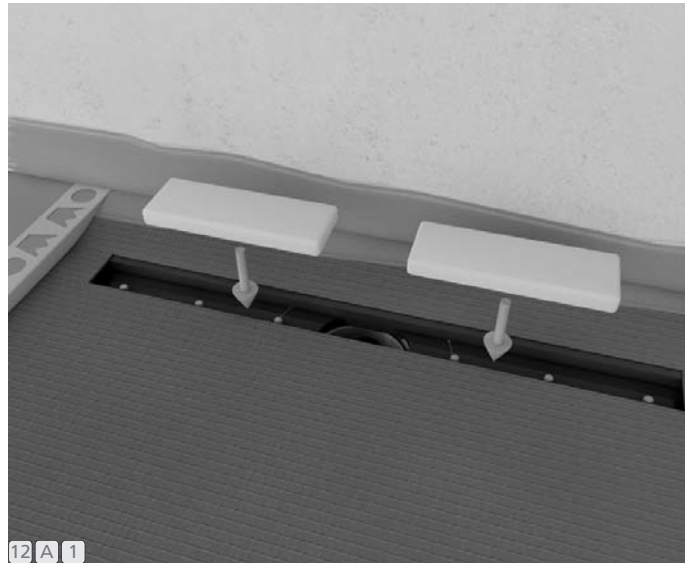

12 A 1

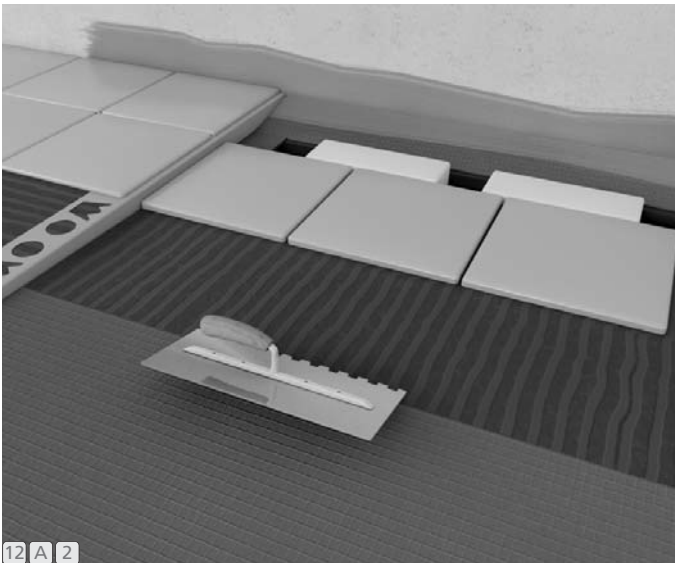

12 A 2

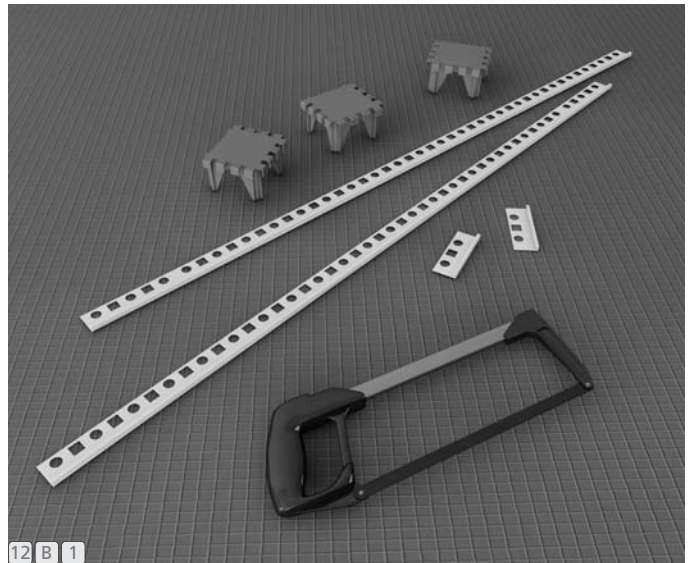

12 B 1

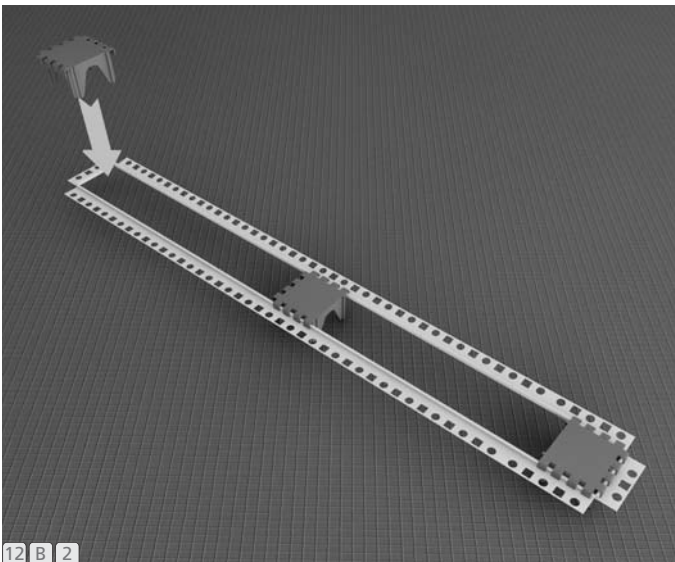

12 B 2

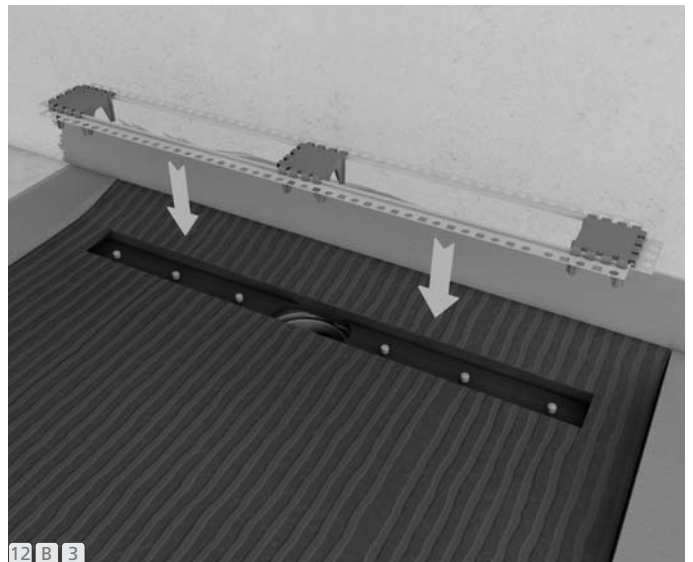

12 B 3

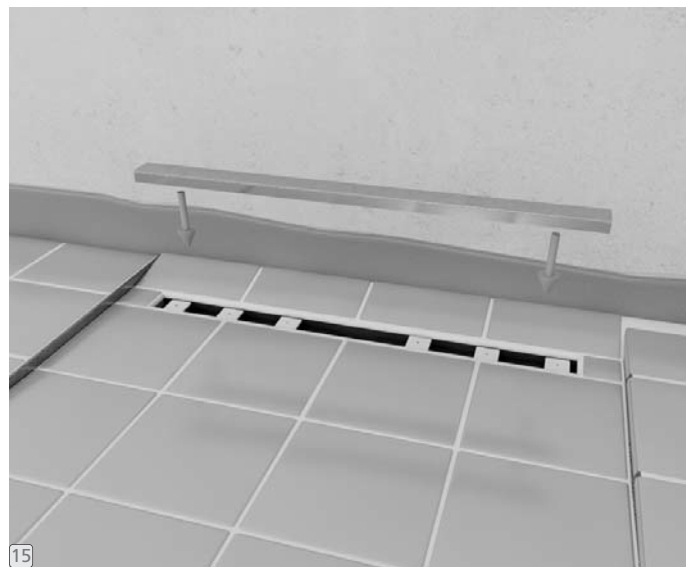
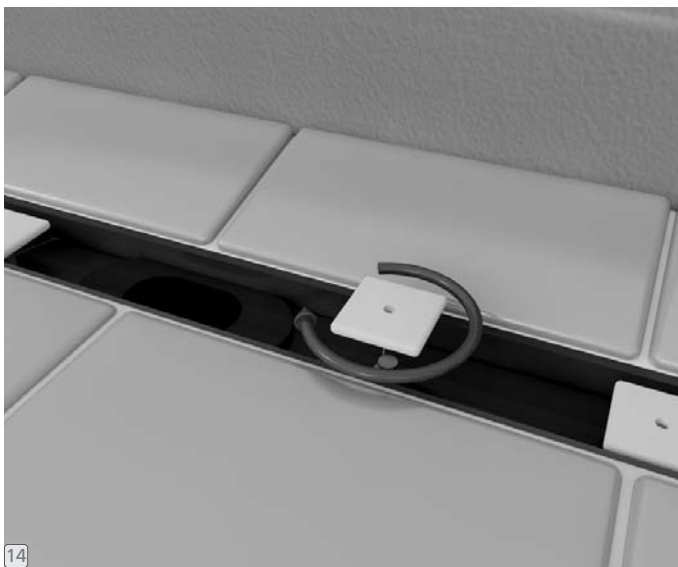
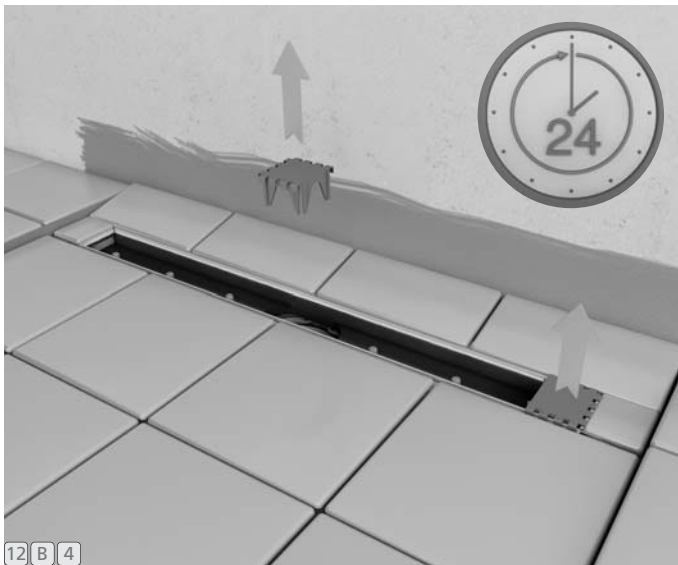

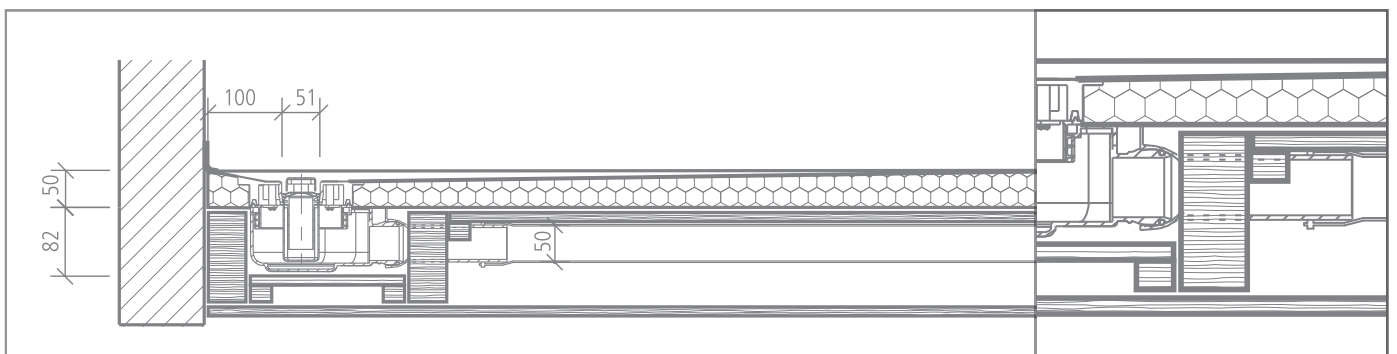
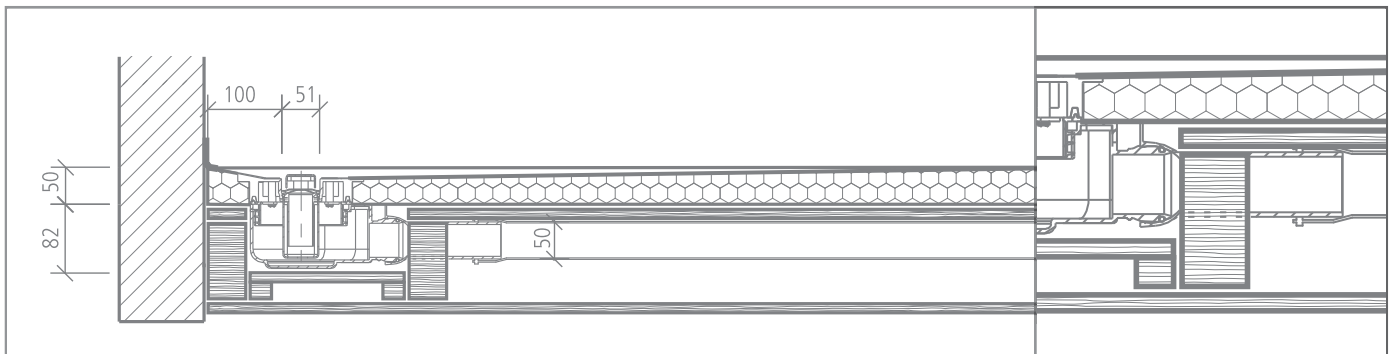
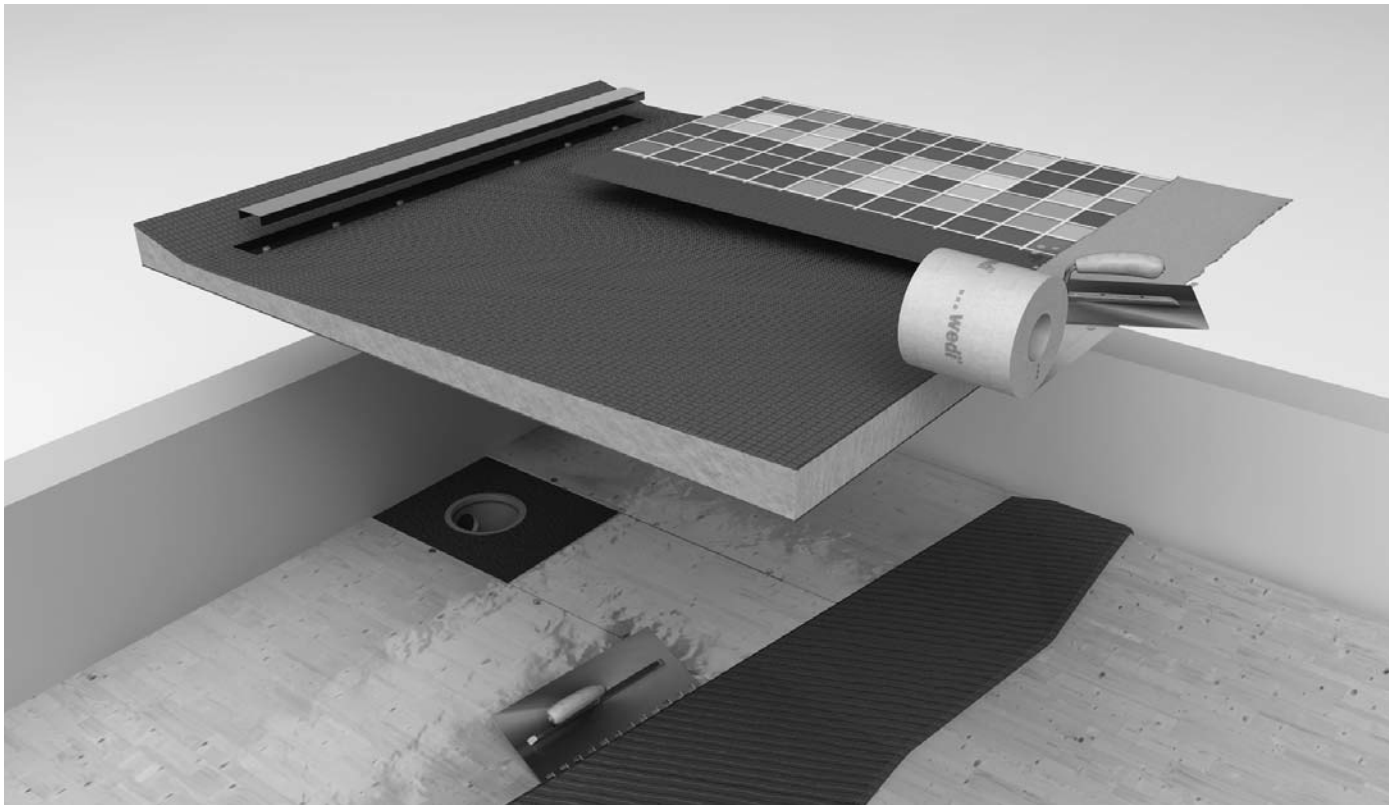

i Hinweis: Bei dieser Einbauvariante halten Sie bitte Rücksprache mit dem Statiker.
 Note: Please consult with a structural engineer about this installation variant.
 Remarque: Pour ce type de montage, merci de consulter un staticien.
 Merknad: Vennligst rådfør deg med den byggtknisk ansvarlige i forbindelse med denne monteringsvarianten.

Henvisning: Ved denne indbygningsvariant bør der rettes forespørgsel til en statiker.
 Nota: Con esta variante de montaje, consulte al especialista en estructuras estáticas.
 Information: Var god kontakta statikern när det gäller denna monteringsvariant.
 Nota: per questa variante di montaggio siete pregati di consultare previamente i tecnico strutturista.

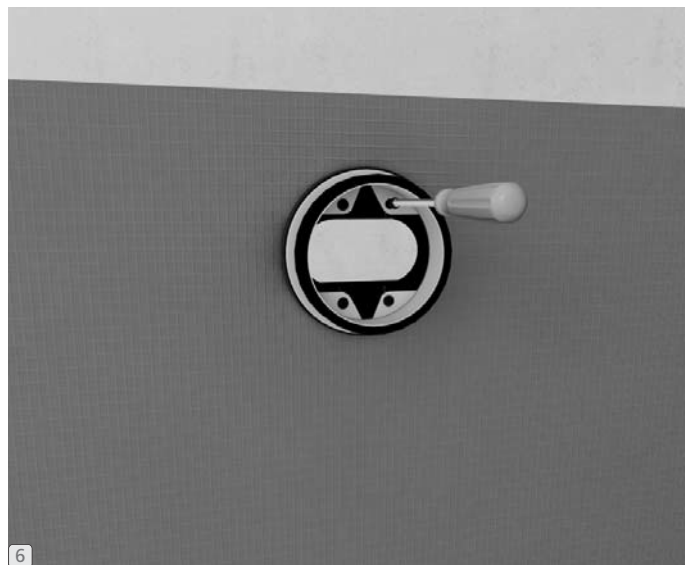
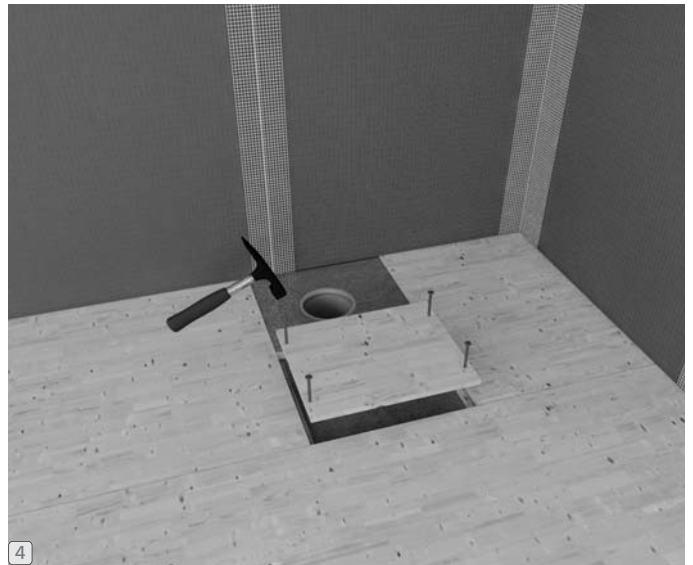
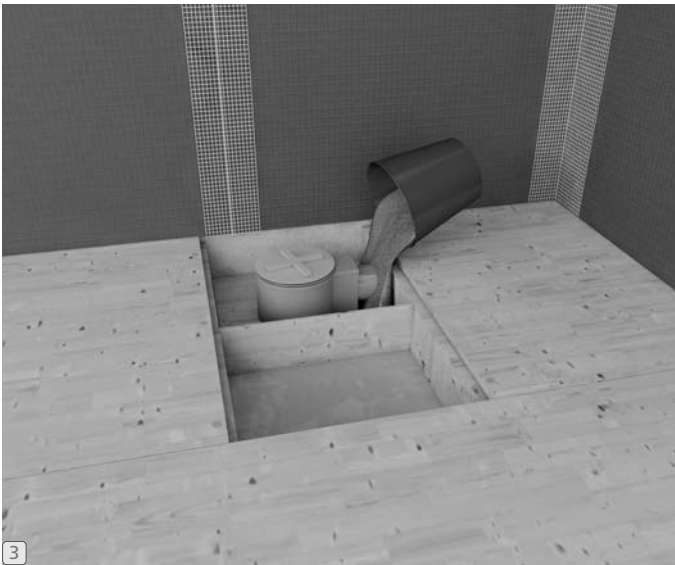
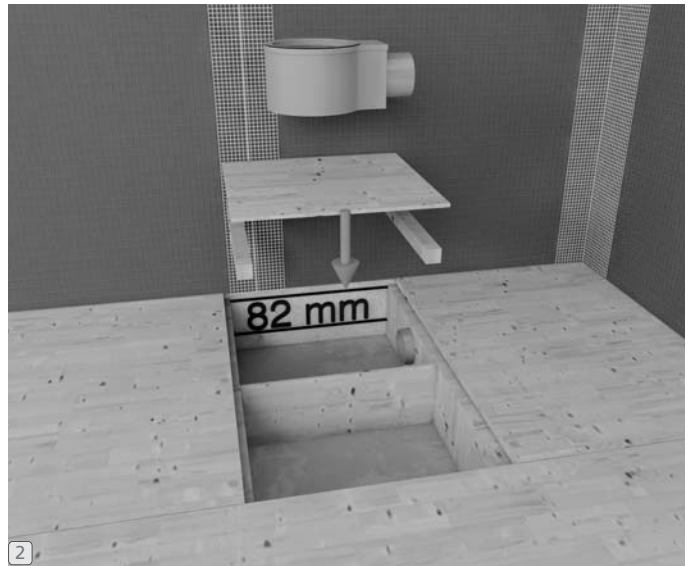
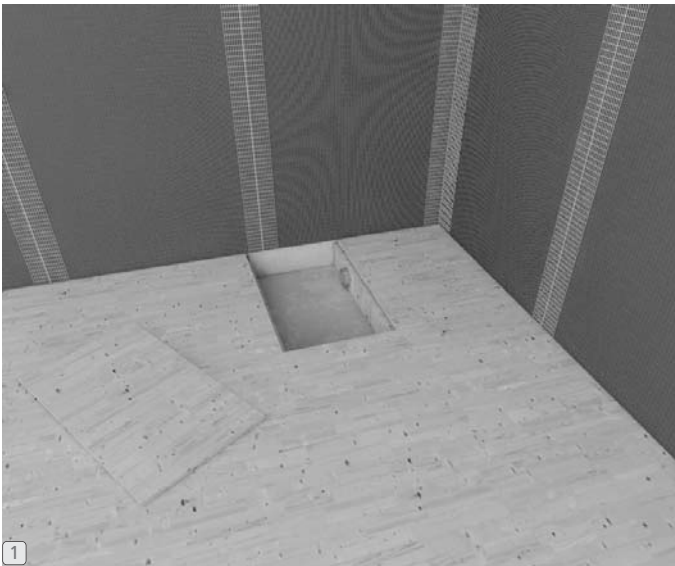

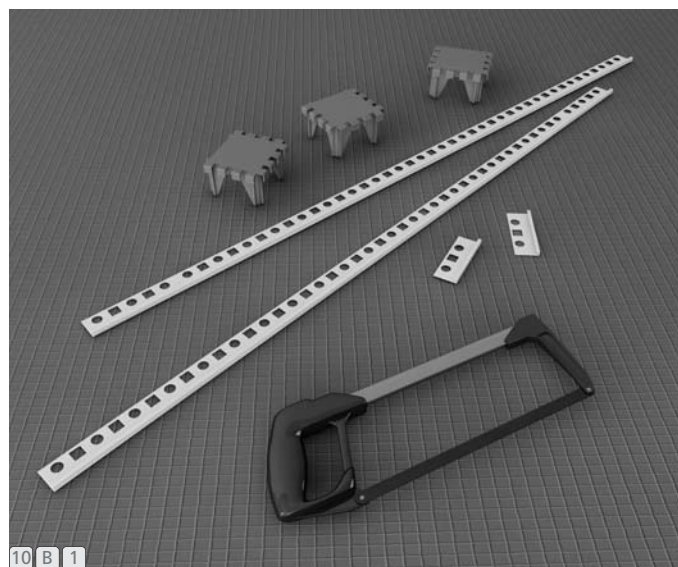
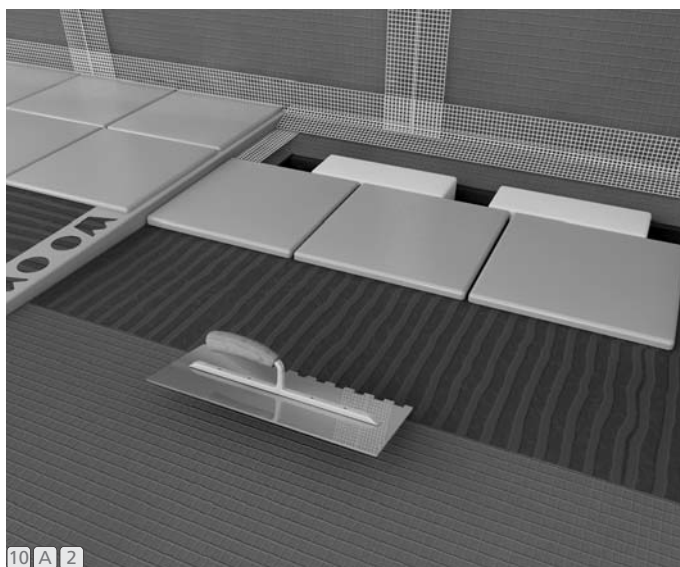
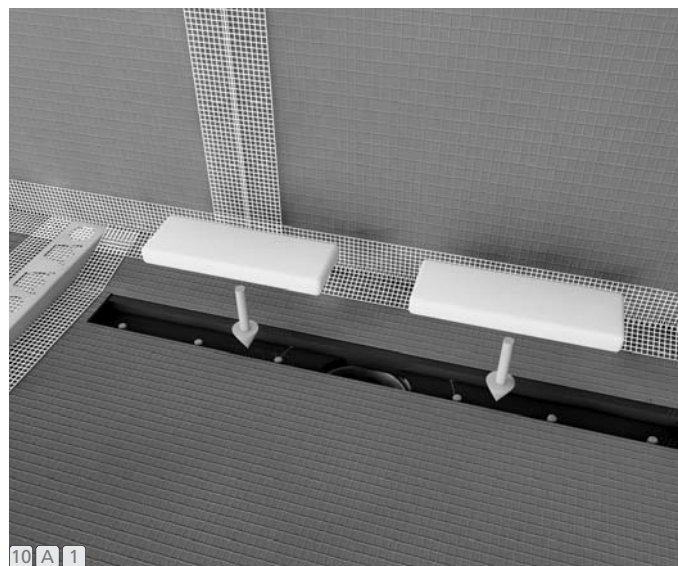
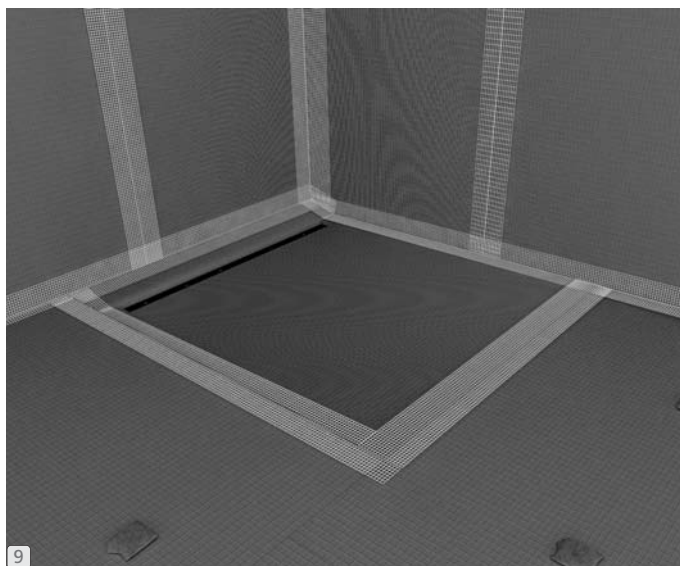
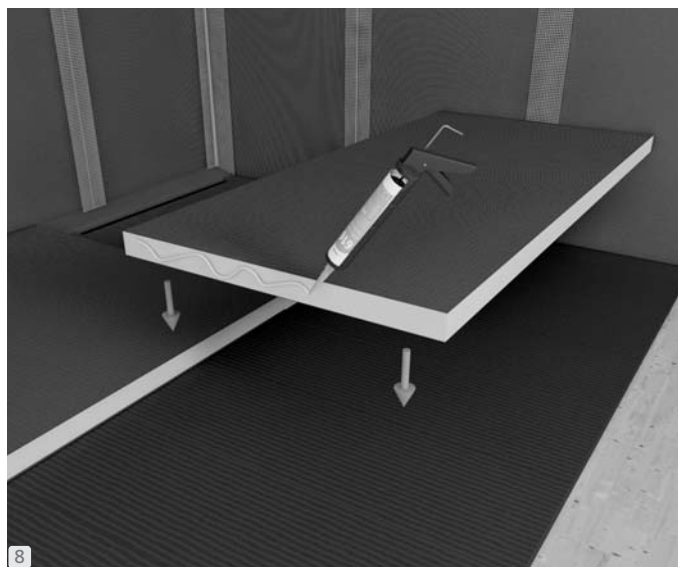

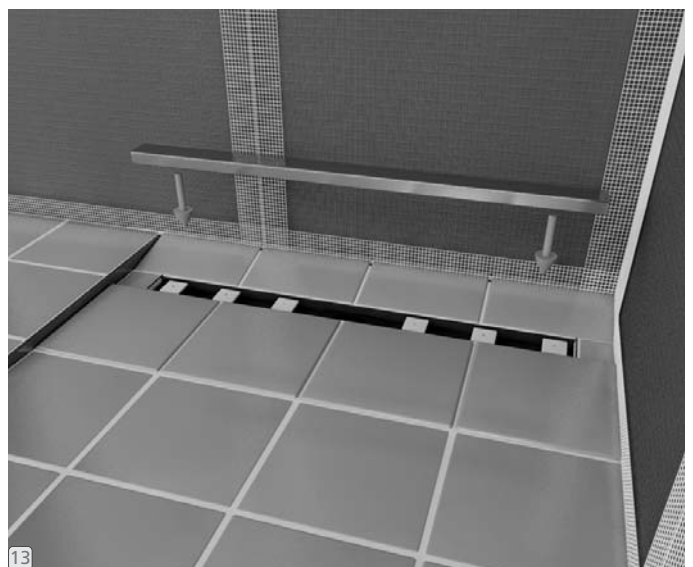
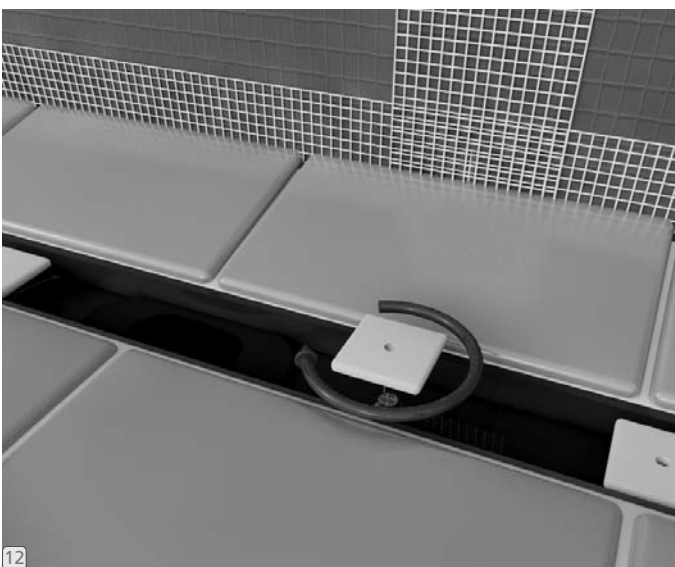
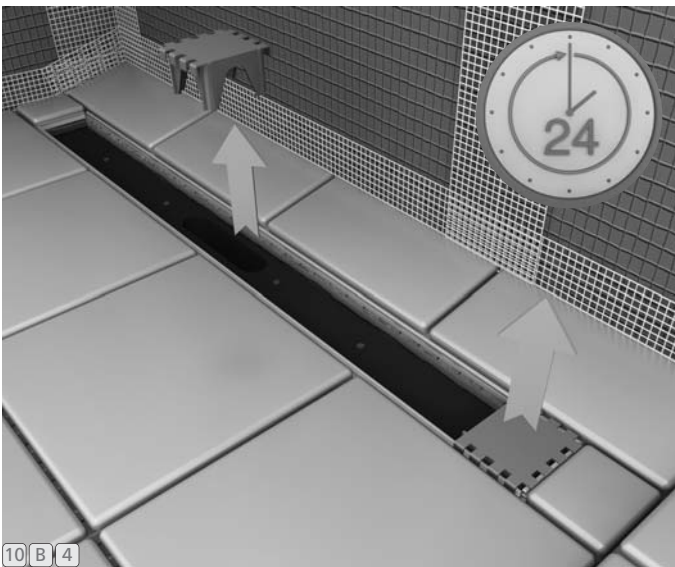
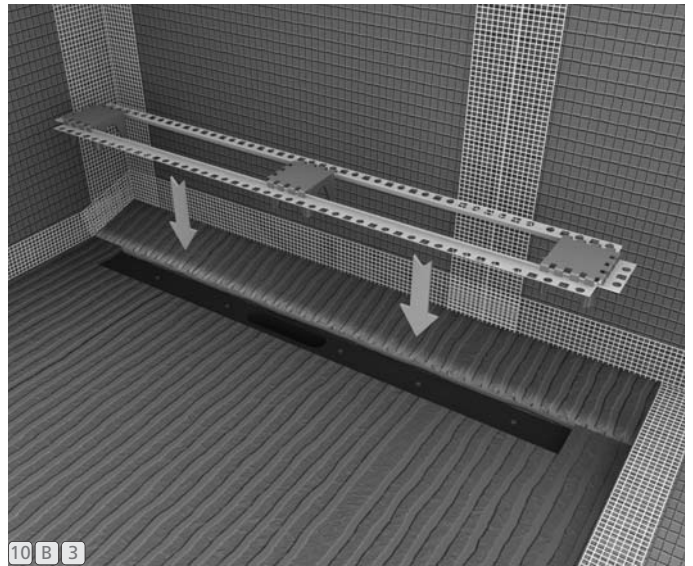
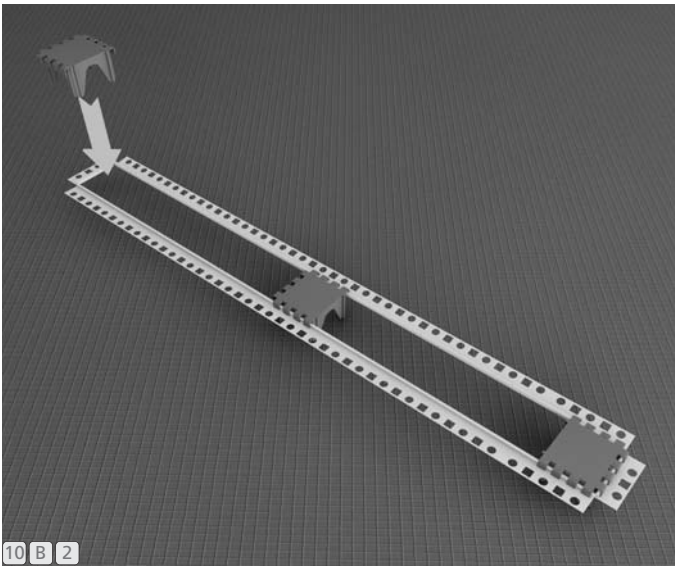

... **wedi**[®]

wedi GmbH
Hollefeldstraße 51 · D-48282 Emsdetten
Tel. +49 2572 156-0 · Fax +49 2572 156-133
info@wedi.de · www.wedi.eu